

1) CONFIGURE YOUR LAYOUT

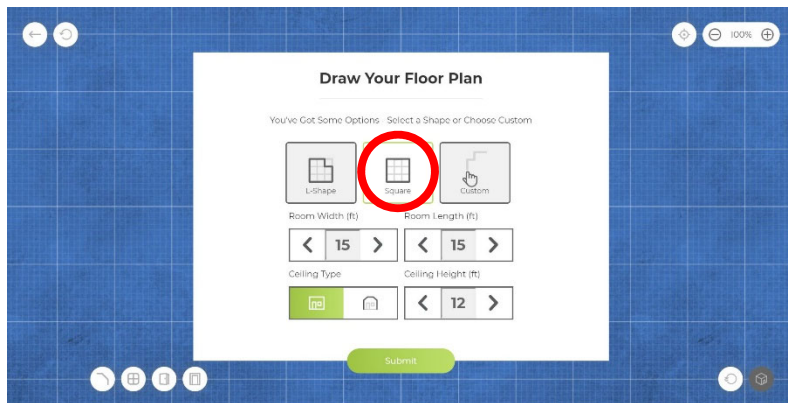

ROOM SETUP PHASE

- Choose **Square** for your initial room shape (L Shape / Custom are for specific or complex layouts)
- Use the left and right arrows to set your room width and length, followed by ceiling type and height (these can be adjusted later).

- The left button under ceiling type (flat) is most common.
- The default ceiling height is set to 12 feet, however 8 and 9 foot high ceilings are most common.

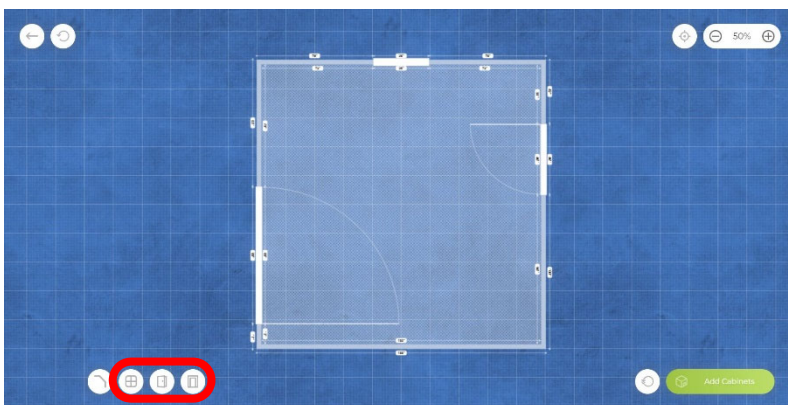

ROOM DRAWING PHASE

- Use the **Windows, Doors, and Entryways buttons** to set items in the floorplan.
- Doors will all show door swing, even on openings without doors.



- The Entryways button does not pull up a menu. Once clicked you simply need to click on a wall to add an entryway.
- Once placed, you can adjust the size of the entryway once placed by dragging the **arrow icons** at the ends of it.

- Once placed, click and drag doors to slide them along the walls they are placed on.
- Windows can be moved up and down on the wall in the Add Cabinets phase.
- Use the Undo button in the top left corner to undo the most recent change to your floorplan drawing.